

**DISCLAIMER**

THIS MAP WAS PREPARED FOR LOCAL PROPERTY ASSESSMENT PURPOSES ONLY. THE PARCELS SHOWN HEREON MAY NOT COMPLY WITH STATE AND LOCAL SUBDIVISION ORDINANCES. NO LIABILITY IS ASSUMED FOR THE USE OF THE INFORMATION HEREON. R & T CODE SEC. 327, 408.3, ETC.

REVISED: 7/09/2015  
REASON: 2014-0036185  
CAD TECH: NFL

S. 1/2 OF SE. 1/2 OF SE. 1/4 OF SEC. 25, T.17S., R.26E., M.D.B.&M.

TAX CODE AREA  
007-006

060-11

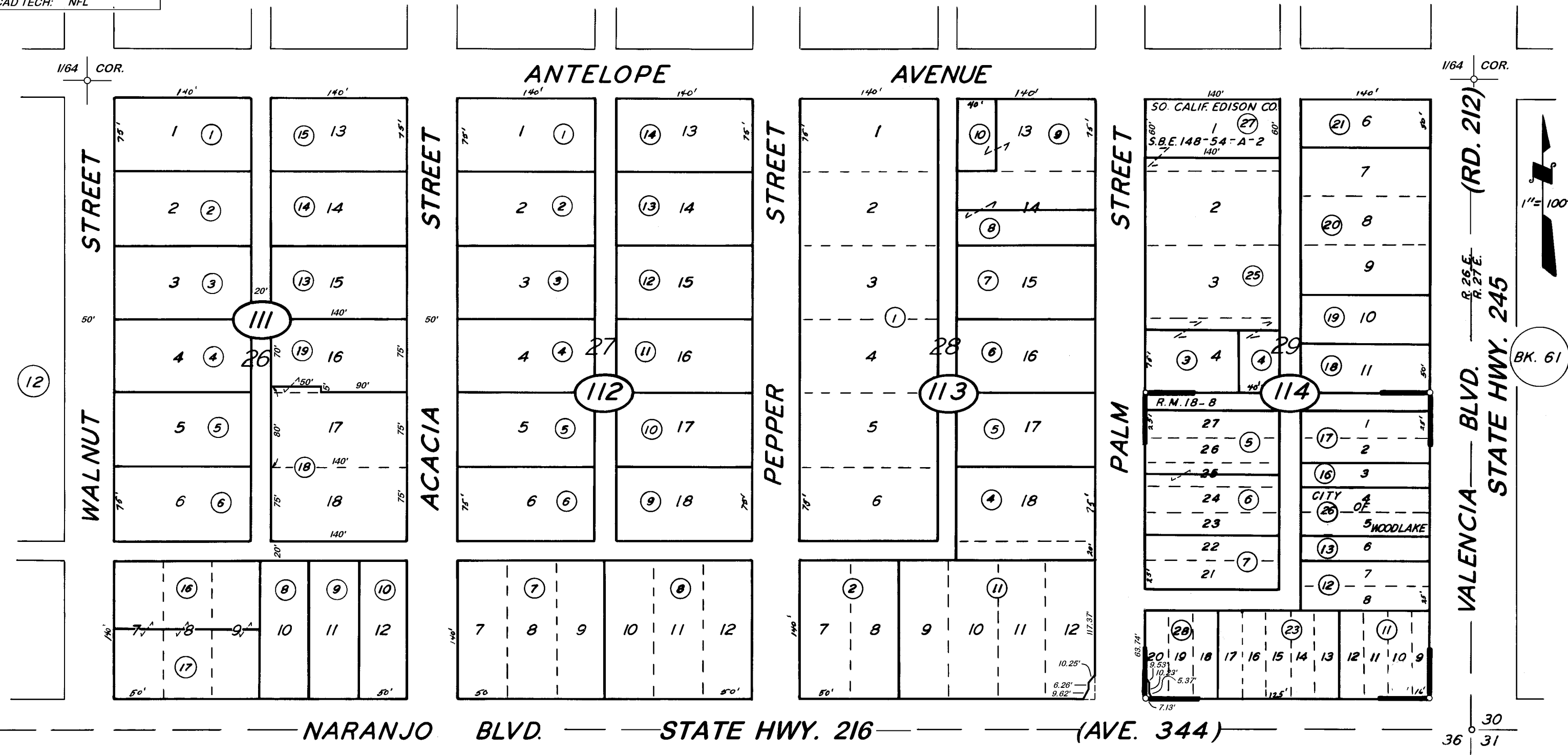

NARANJO BLVD. STATE HWY. 216 (AVE. 344)

VALENCIA BLVD. (RD. 212)  
STATE HWY. 245

CITY OF WOODLAKE  
ASSESSOR'S MAPS BK. 060, PG. 11  
COUNTY OF TULARE, CALIF.

POR TOWN OF WOODLAKE, R.M. 11-23  
VALENCIA ADD., R.M. 18-8

NOTE - ASSESSOR'S BLOCK NUMBERS SHOWN IN ELLIPSES  
ASSESSOR'S PARCEL NUMBERS SHOWN IN CIRCLES

12

10

BK. 61

13

30  
31