

EXETER TOWNSITE, BLKS. 3, 4, 11, 12 & 13

TAX CODE AREA **135-14**
002-014

DISCLAIMER
THIS MAP WAS PREPARED FOR LOCAL PROPERTY ASSESSMENT PURPOSES ONLY. THE PARCELS SHOWN HEREON MAY NOT COMPLY WITH STATE AND LOCAL SUBDIVISION ORDINANCES. NO LIABILITY IS ASSUMED FOR THE USE OF THE INFORMATION HEREON.

REVISED: 11/18/2013
REASON: 2005-0132120
CAD TECH: LLB

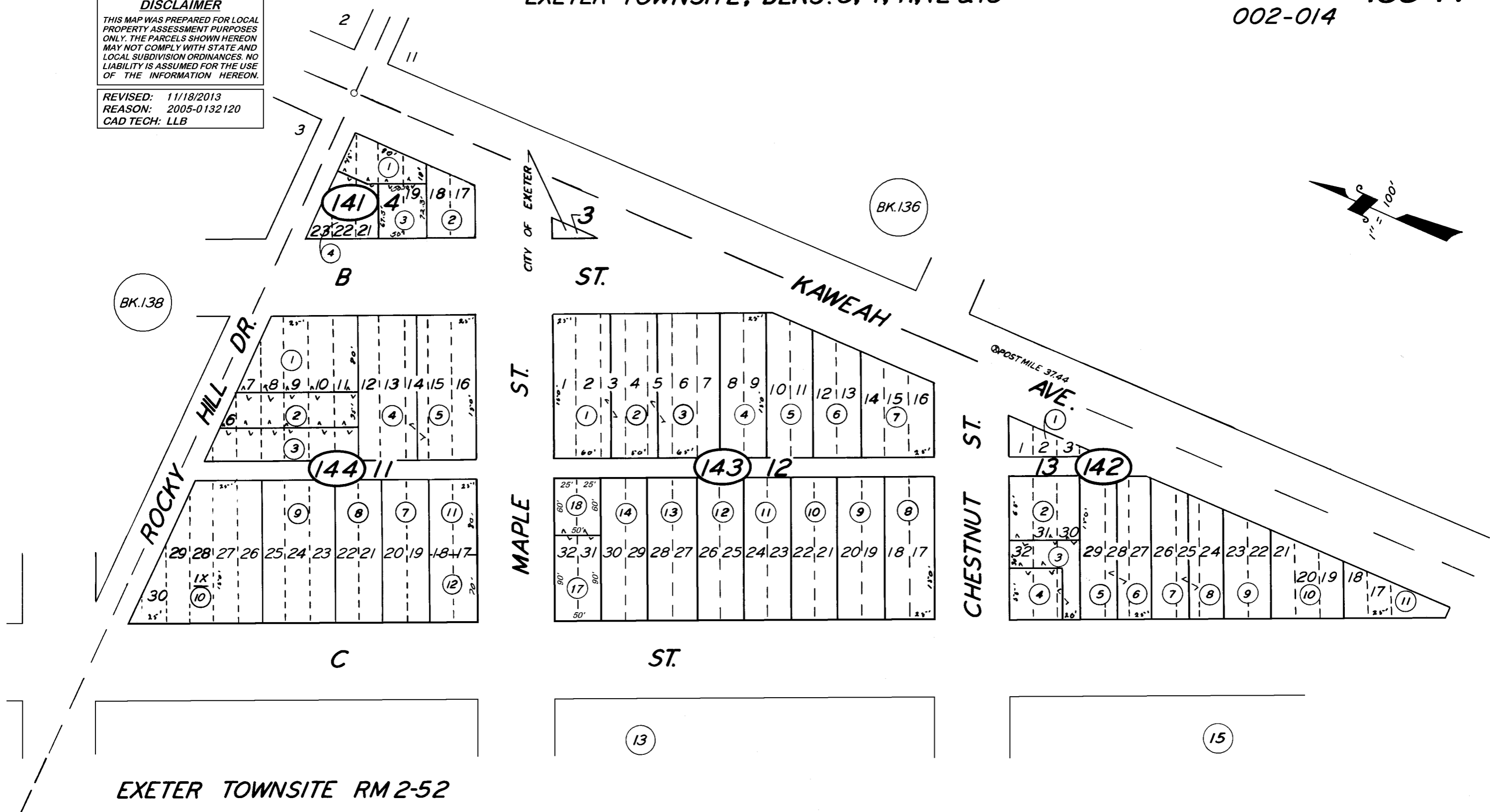
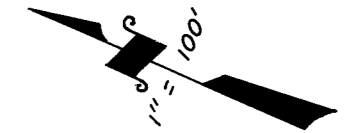

EXETER TOWNSITE RM 2-52

CITY OF EXETER
ASSESSOR'S MAPS BK. 135, PG. 14.
COUNTY OF TULARE, CALIF.

NOTE — ASSESSOR'S BLOCK NUMBERS SHOWN IN ELLIPSES
ASSESSOR'S PARCEL NUMBERS SHOWN IN CIRCLES