

GOSHEN TOWNSITE, ORIGINAL BLKS. 42, 52, POR. 43, 51,
& POR. TRACT 312.

TAX CODE AREA **75-14**
153-060
153-049

NE COR. OF S/2
OF NW/4 OF
SEC. 19-18/25

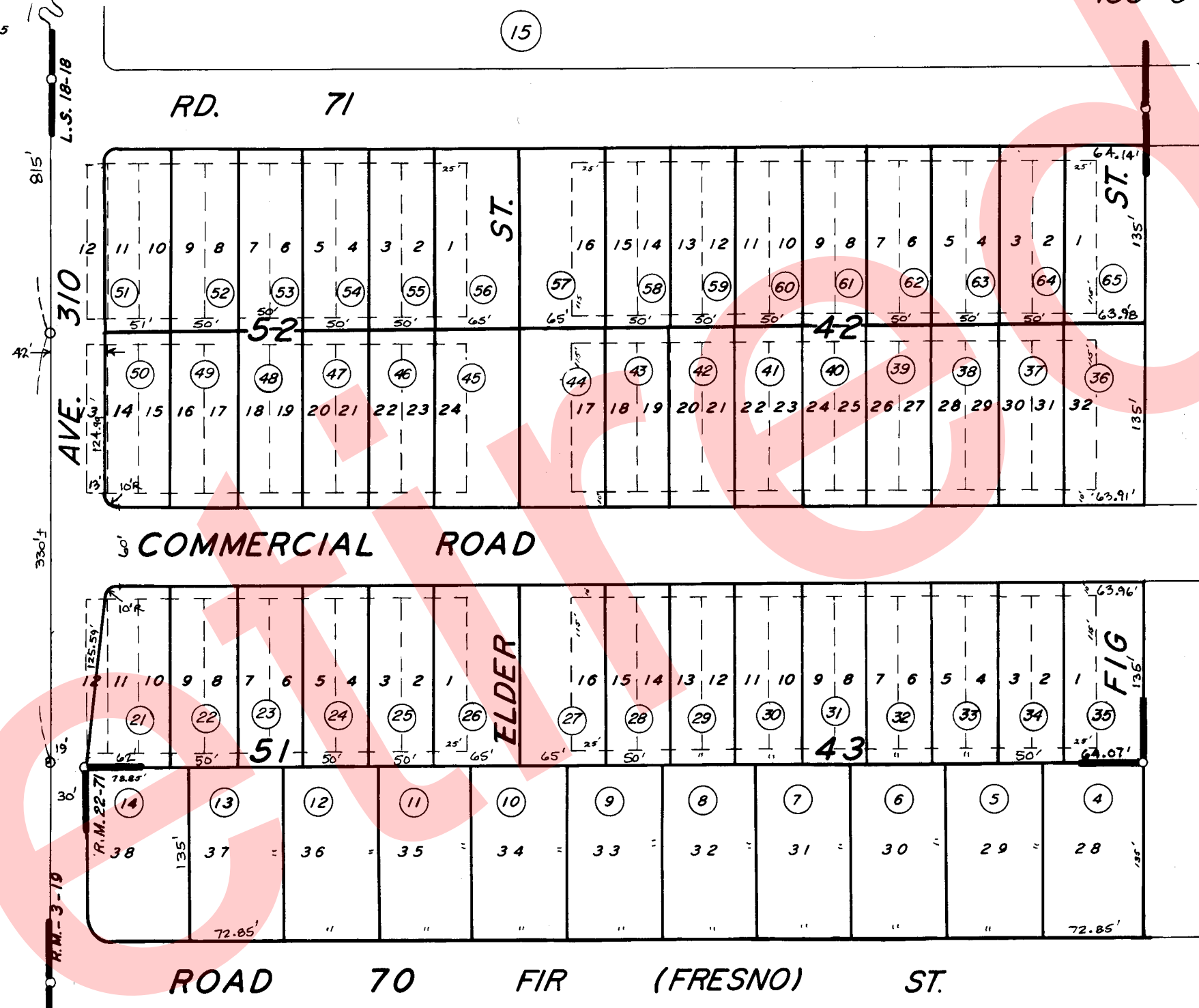
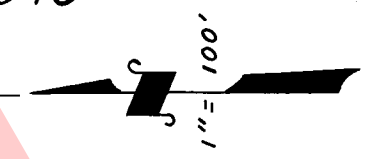

NOTE:
ROADS ABAND. PER
V. 2158, P. 24 O.R. &
V. 2184, P. 390 O.R. &
V. 2440, P. 577-588 O.R.;
PARTS REOPENED PER
DOC. 62996 REC. 11/1/90 &
V. 4733, P. 512 O.R.

NOTE: ABANDONMENT REDUCING MOST 80' STREETS TO
60 & 100' STREETS TO 80' RECORDED IN VOL. 2184, PG. 390. O.R.

*AUTOCAD
2/2/01*

POR. GOSHEN TOWNSITE, R.M. 3-19. ASSESSOR'S MAPS BK. 75, PG. 14.
POR. TRACT 312, R.M. 22-71. COUNTY OF TULARE, CALIF.
RECORD OF SURVEY, L.S. 18-18

NOTE - ASSESSOR'S BLOCK NUMBERS SHOWN IN ELLIPSES
ASSESSOR'S PARCEL NUMBERS SHOWN IN CIRCLES

