

153-060  
153-049  
153-007

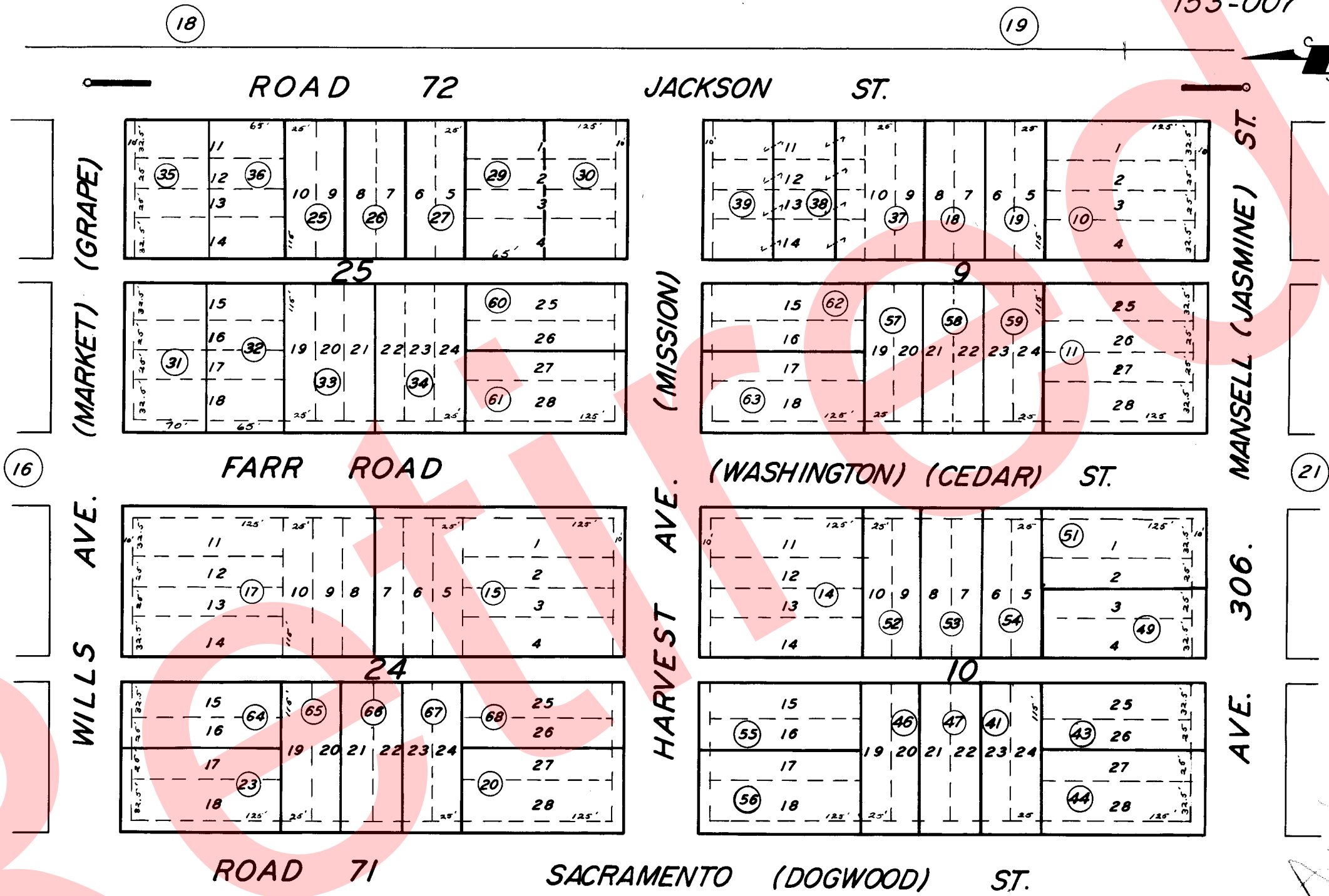

NOTE: ABANDONMENT REDUCING MOST 80' STREETS TO 60'  
& 100' STREETS TO 80' RECORDED IN VOL. 2184, PG. 390

POR. RESUB. OF POR. GOSHEN TOWNSITE, R.M.-9-7.

ASSESSOR'S MAPS BK. 75, PG. 20.

COUNTY OF TULARE, CALIF.

NOTE - ASSESSOR'S BLOCK NUMBERS SHOWN IN ELLIPSES  
ASSESSOR'S PARCEL NUMBERS SHOWN IN CIRCLES

*Auto CAD  
2/21/01*